

PTU-D46 FAMILY

Options

PTU-D46-xx-W
 PTU-D46-xx-N
 PTU-D46-xx-E

These options are available separately or in combination for the PTU-D46 family of Pan-Tilt Units. To specify option, append appropriate letter(s) to the base part number. For example: "PTU-D46-17-WE" specifies a PTU-D46-17 with both Weatherized and Extended I/O options.

Weatherized Option ("W")

The Weatherized option modifies the standard Pan-Tilt Unit for outdoor use. The following modifications are part of this option, and result in an IP65 rating for the Pan-Tilt head:

- Clear epoxy coating added to motors
- Silicone sealant around screws and cables attachments
- Rubber seals and plastic washers around knobs
- Gasket sealing around outside edges of motors
- Stainless steel screws
- Interfacial seal on Pan-Tilt head connector

NOTE: the Pan-Tilt Controller is not weatherized and should be housed in an appropriate enclosure.

Nodal Gimbal Option ("N")

The Nodal Gimbal option is designed to provide the ability to mount a payload with it's center aligned to the pan and tilt axes of rotation. A common application for the Nodal option is mounting a camera so that its focal point is at the axes centers. This allows all camera pan-tilt movement to be modeled as pure rotations (no translation). The diagram shows two alternate mounting options using the Nodal Gimbal (bracket above payload, and bracket below payload).

NOTE: Nodal option units cannot be converted to non-nodal units after manufacture.

Extended I/O Option ("E")

The "EIO" option provides two additional serial ports and an analog joystick port. The analog joystick port can be used for direct control of the pan-tilt with no Host Computer. The additional serial ports (CHA, CHB) are multiplexed through the Host Interface and can be used to communicate with a payload device such as a camera.

Other

The PTU-D46 is available by special order with other configurations and options including:

- Pan-only unit
- Weatherized Controller unit
- Custom payload bracket

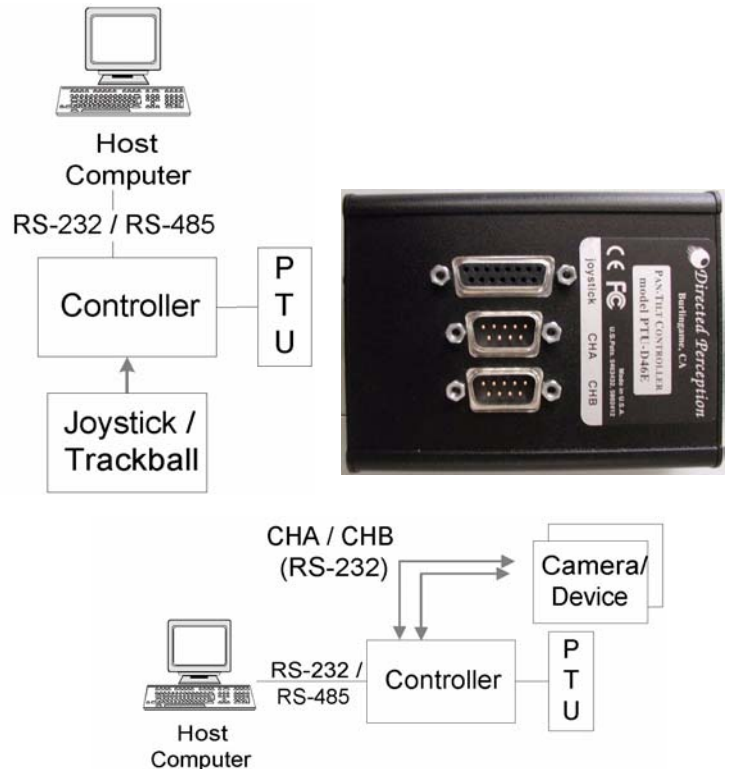
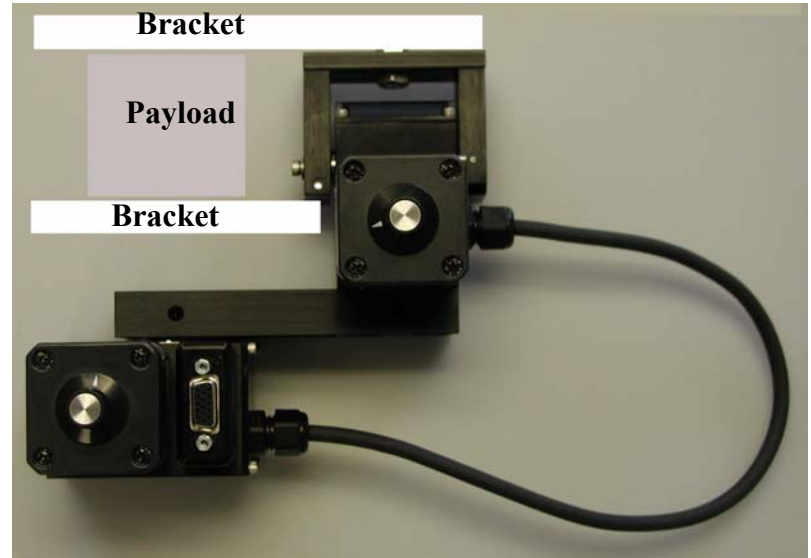

PTU-D46 NODAL GIMBAL Dimensions

PTU-D46-xx-N

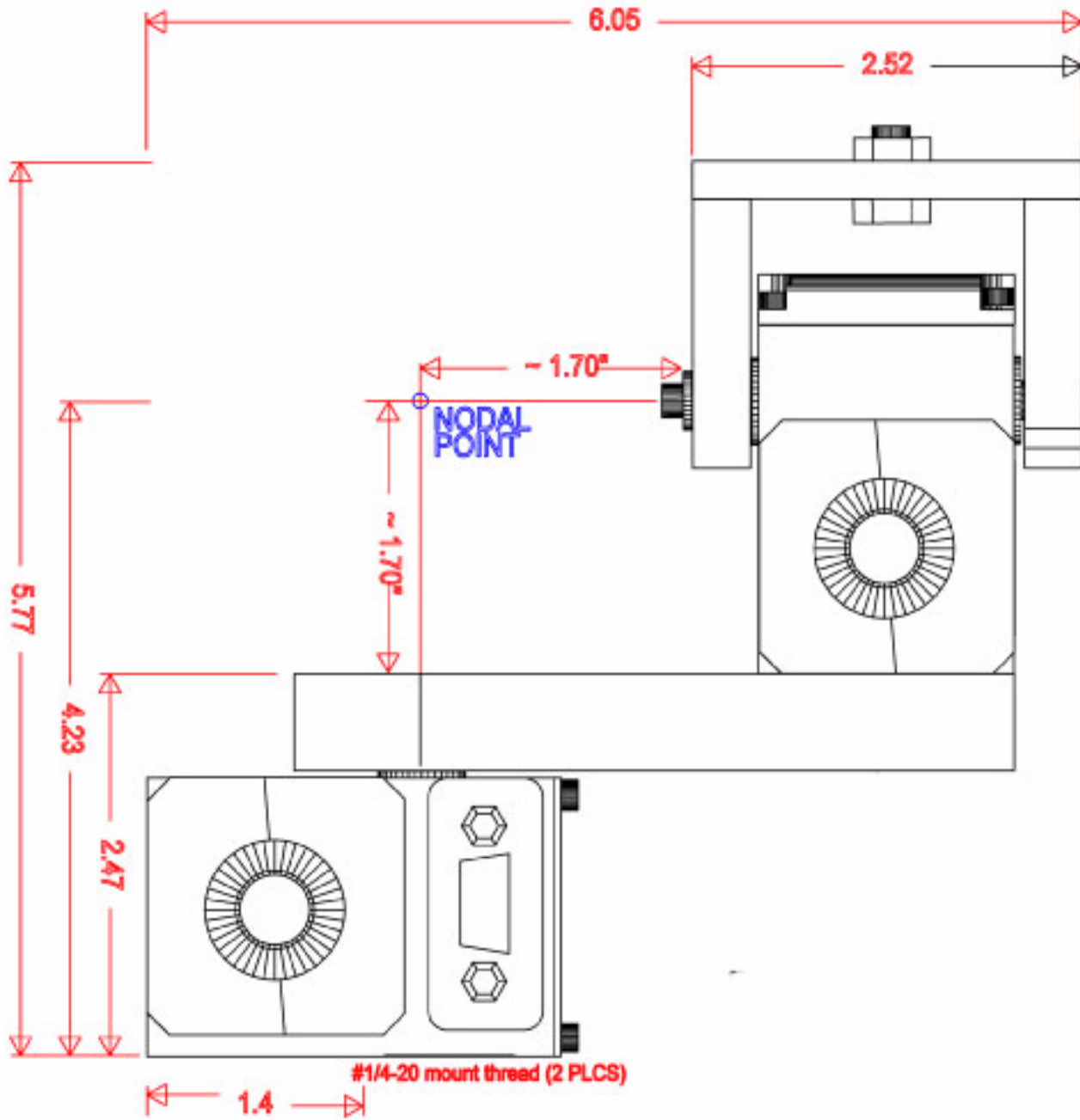

Specifications subject to change without notice.

PTU-D46 Networking Options

PTU-D46-xx-x

PTU Network Starter Kit (PTU-DNET-SK) consists of two (2) "Y-connectors", one (1) data connection cable, and two (2) network terminators. Additional PTU controllers may be networked using PTU Network Additional Unit Kit (PTU-DNET-AU) which includes one (1) "Y-connector", and one (1) data connection cable. See the PTU-D46 User Manual for further details.

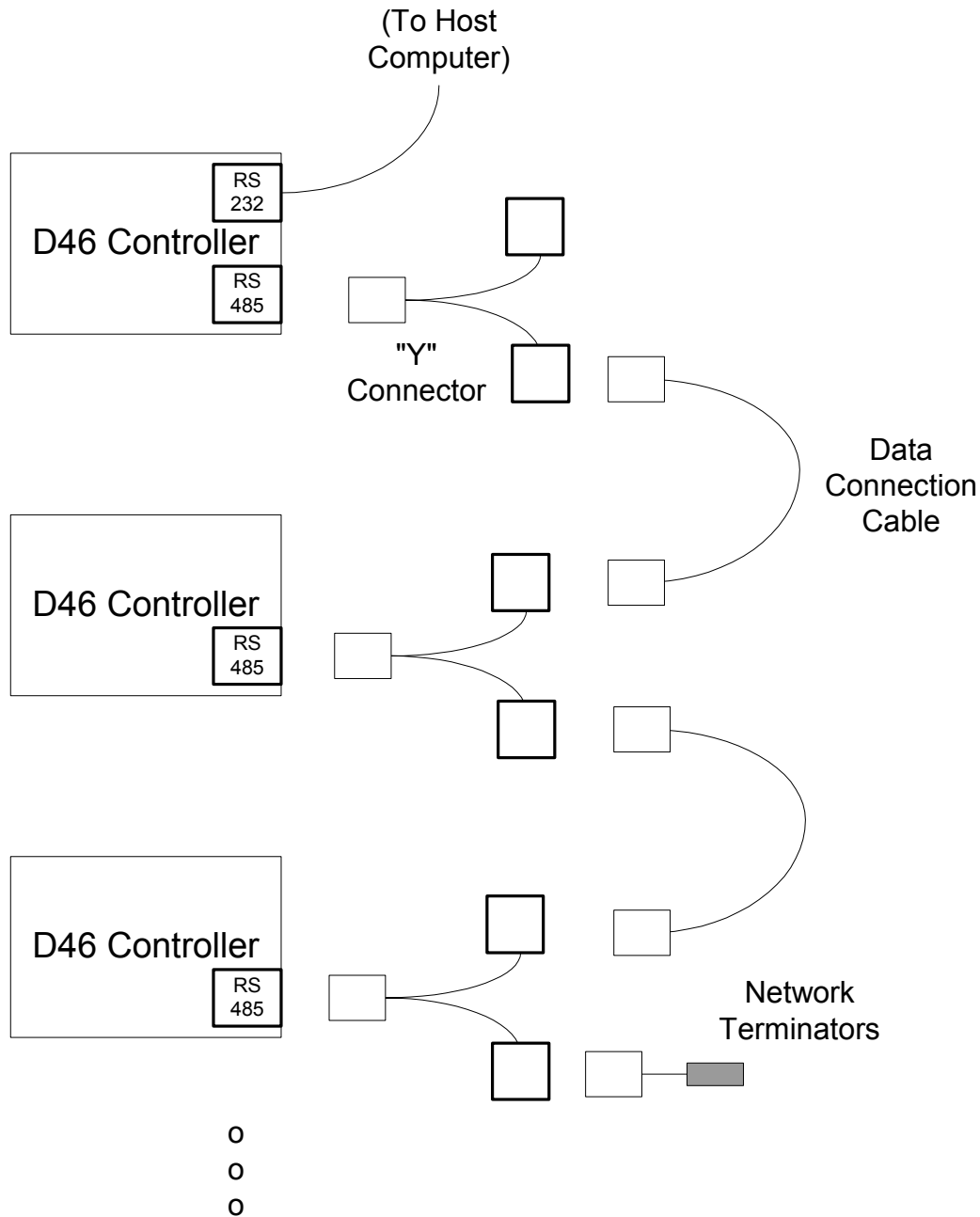

Specifications subject to change without notice.

PTU-D46 Side Mount Bracket

D46AC-BKT-ZSTD

The D46AC-BKT-ZSTD provides a side or side+top mounting option for PTU-D46 pan-tilt models. Side mounting lowers the payload center of gravity and can provide better performance and higher payload capacities. Care must be taken to assure that mounted payload clears the unit through the full range of motion. The D46AC-BKT-ZSTD is compatible with standard and Nodal units (though range of motion is more constrained with Nodal units).

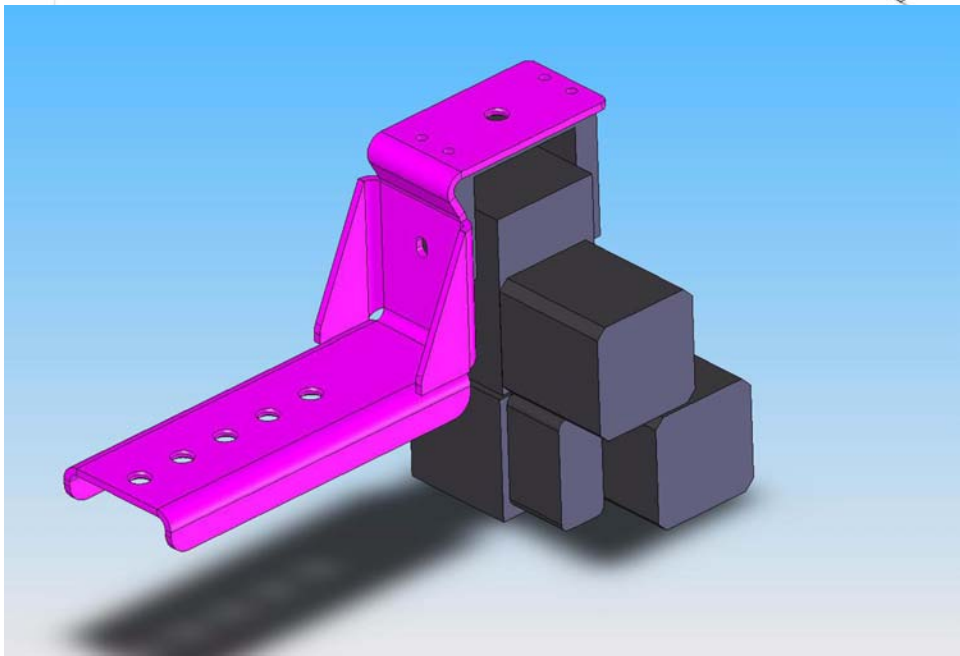
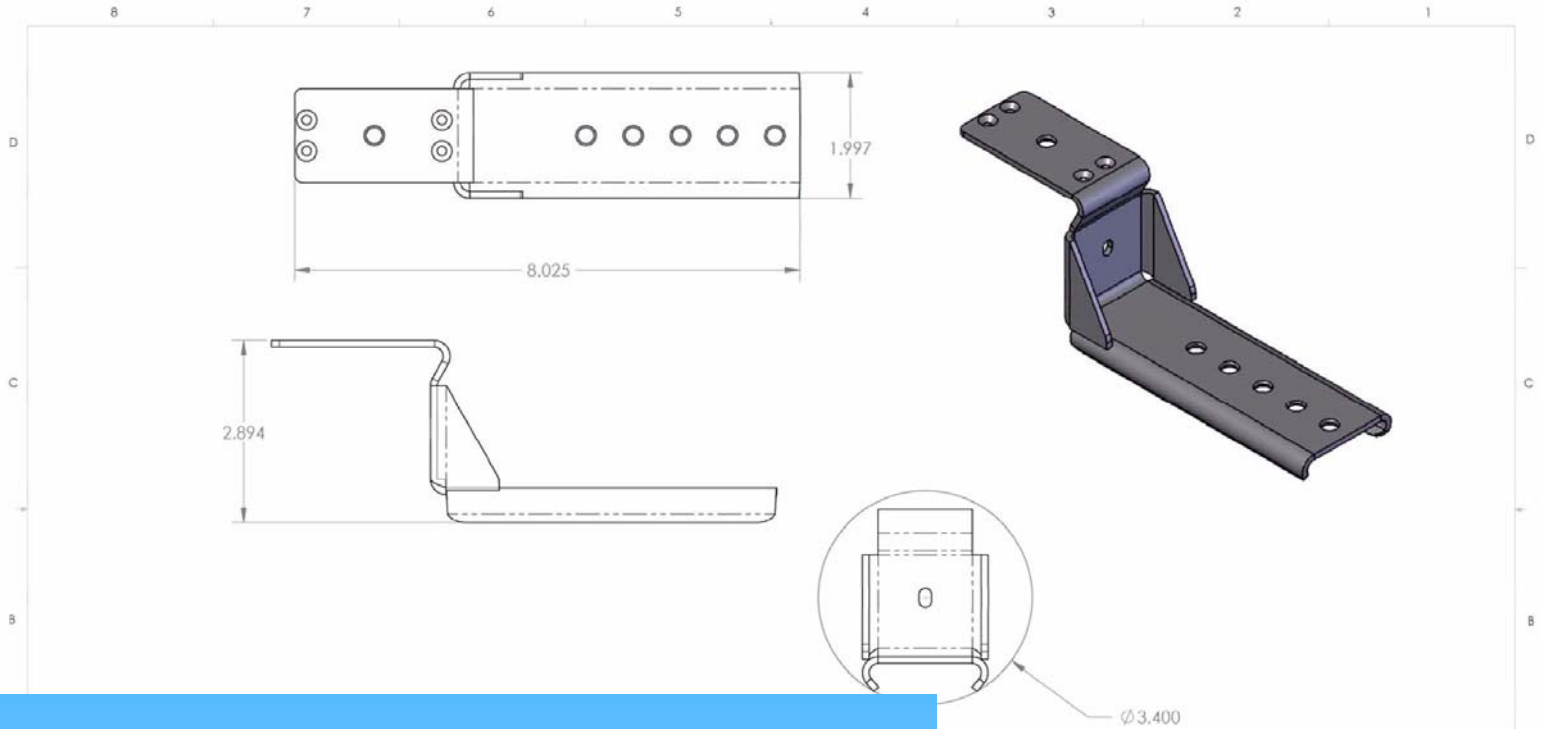

UNLESS OTHERWISE SPECIFIED:		NAME:	DATE:
DIMENSIONS ARE IN INCHES		DRAWN:	
TOLERANCES:		CHECKED:	
FRACTIONAL ±.032		ENG APPR.:	
ANGULAR: MACH: ±.5 BEND ±1		MFG APPR.:	
TWO PLACE DECIMAL ±.01		G.A.:	
THREE PLACE DECIMAL ±.005		COMMENTS:	
INTERPRET GEOMETRIC TOLERANCING PER:			
MATERIAL: 12Ga CRS			
FINISH: SATIN BLACK			
DO NOT SCALE DRAWING			

DIRECTED PERCEPTION SIDE PAYLOAD BRACKET		
SIZE	PART NO.	REV
B	D46AC-BKT-Zstd	C
SCALE: 1:1.5WEIGHT:	SHEET 1 OF 1	